

1 Introduced by the Council President at the request of the Mayor:
2
3

4 **ORDINANCE 2025-**

5 AN ORDINANCE CLOSING AND ABANDONING AND/OR
6 DISCLAIMING AN UNOPENED AND UNIMPROVED PORTION
7 OF KONA AVENUE AS RECORDED IN PLAT BOOK 8, PAGES
8 23-25, OAKWOOD VILLA ESTATES, OF THE CURRENT
9 PUBLIC RECORDS OF DUVAL COUNTY, FLORIDA, LOCATED
10 IN COUNCIL DISTRICT 1, AT THE REQUEST OF NORTH
11 FLORIDA SCHOOL OF SPECIAL EDUCATION, INC.,
12 SUBJECT UNTO RESERVATION TO CITY AND JEA OF A
13 NON-EXCLUSIVE ALL-UTILITIES, FACILITIES, AND
14 ACCESS EASEMENT ON, OVER, UNDER, THROUGH, AND
15 ACROSS THE CLOSURE AREA; PROVIDING FOR APPROVAL
16 SUBJECT TO CONDITIONS; PROVIDING AN EFFECTIVE
17 DATE.
18

19 **BE IT ORDAINED** by the Council of the City of Jacksonville:

20 **Section 1. Closure and Abandonment.** An unopened and
21 unimproved portion of Kona Avenue as recorded in Plat Book 8, Pages
22 23-25, Oakwood Villa Estates, of the current public records of Duval
23 County, Florida, located in Council District 1, a depiction and
24 description of which is attached hereto as **Exhibit 1** and incorporated
25 herein by this reference, is hereby closed and abandoned and/or
26 disclaimed at the request of North Florida School of Special
27 Education, Inc. (the "Applicant"), subject unto reservation unto City
28 and JEA of a non-exclusive all-utilities, facilities, and access
29 easement on, over, under, through, and across the closure area.

30 The Applicant has paid the closure application fees of \$2,091.00
31 and this sum has been deposited into the City's General Fund. This

1 closure request was reviewed and approved by the various city, state,
2 and utility agencies that might have an interest in the right-of-way
3 and there were no objections to the Applicant's request.

4 **Section 2. Purpose.** The Applicant has requested this
5 closure to connect its adjacent properties and create the additional
6 parking required under code as a result of renovating and utilizing
7 the former Lee & Cates building for special needs clients.

8 **Section 3. Hold Harmless Covenant.** The closure and
9 abandonment by the City of its interests in the right-of-way is
10 subject to Applicant's execution and delivery to the City of a Hold
11 Harmless Covenant, in substantially the same form attached hereto as
12 **Exhibit 2** and incorporated herein by this reference. Accordingly, the
13 closure and abandonment of the right-of-way shall not be recorded in
14 the public records until execution and delivery to the City by the
15 Applicant of the required Hold Harmless Covenant.

16 **Section 4. Effective Date.** This Ordinance shall become
17 effective upon signature by the Mayor or upon becoming effective
18 without the Mayor's signature.

19
20 Form Approved:

21 
22 _____

23 Office of General Counsel

24 Legislation Prepared By: Harry M. Wilson, IV

25 GC-#1689310-v1-Kona_Avenue_ROW_Closure.docx

EXHIBIT 1

Kona Ave Closure
RE 120885-0035
Location Map

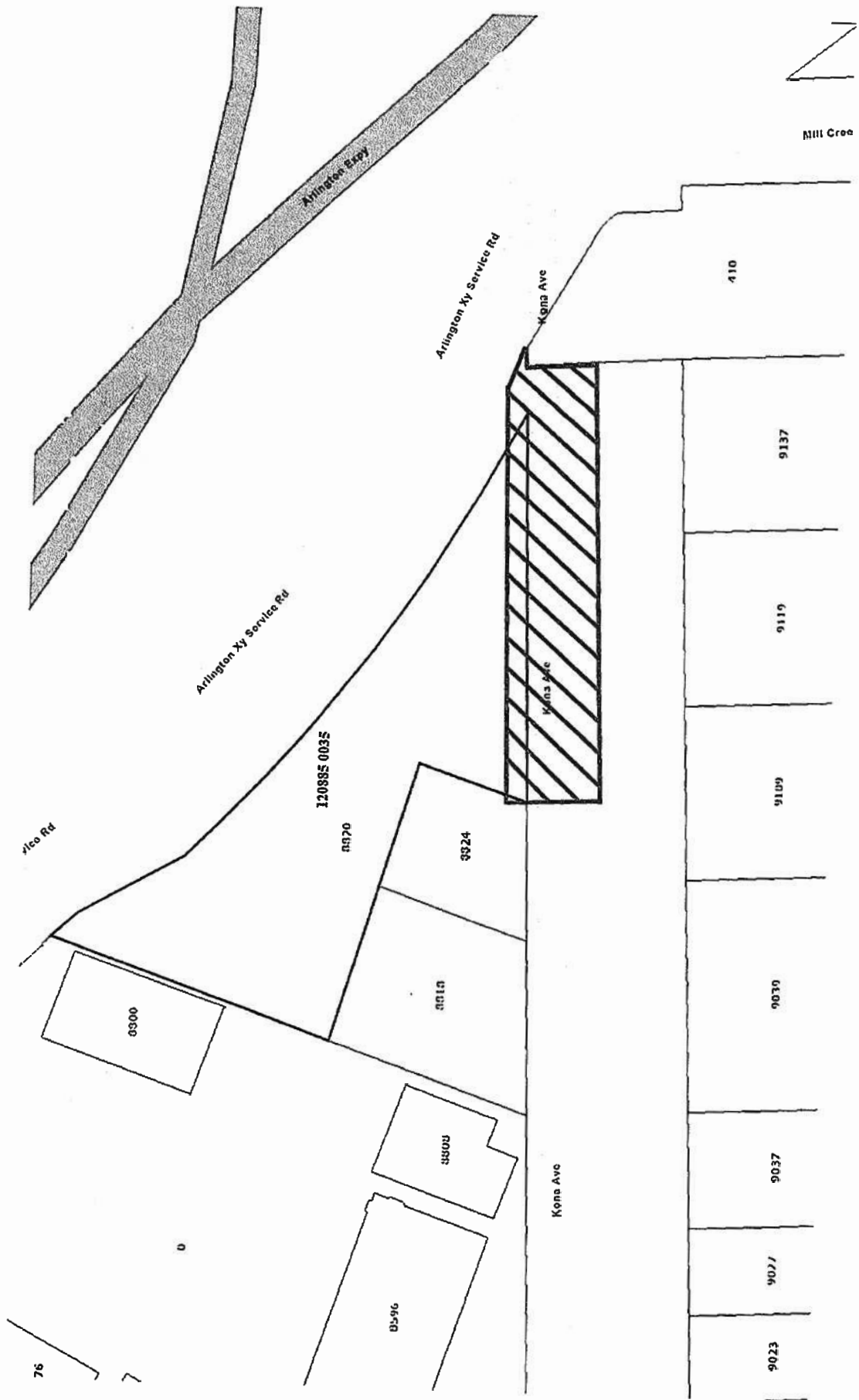

Kona Ave Closure
RE 120885-0035
Aerial Map



MAP SHOWING SKETCH & DESCRIPTION OF A PORTION OF SECTION 52, TOWNSHIP 2 SOUTH, RANGE 27 EAST, DUVAL COUNTY, FLORIDA

PROPOSED CLOSING OF A PORTION OF KONA AVENUE RIGHT OF WAY:

FOR A POINT OF BEGINNING, COMMENCE AT THE INTERSECTION OF THE NORTHERLY RIGHT OF WAY LINE OF KONA AVENUE, A 60 FOOT RIGHT OF WAY AS PER THE PLAT OF OAKWOOD VILLAS, PLAT BOOK B, PAGE 23 OF DUVAL COUNTY & THE SOUTHWESTERLY RIGHT OF WAY LINE OF ARLINGTON EXPRESSWAY SERVICE ROAD; THENCE SOUTH 47°55'39" EAST, ALONG SAID SOUTHWESTERLY RIGHT OF WAY LINE OF ARLINGTON EXPRESSWAY SERVICE ROAD, A VARIABLE WIDTH RIGHT OF WAY AS PRESENTLY ESTABLISHED, A DISTANCE OF 14.39 FEET; THENCE SOUTH 85°57'39" WEST, ALONG SAID SOUTHWESTERLY RIGHT OF WAY LINE OF ARLINGTON EXPRESSWAY SERVICE ROAD, A DISTANCE OF 7.81 FEET; THENCE SOUTH 03°53'56" EAST, A DISTANCE OF 19.89 FEET; THENCE SOUTH 88°30'00" WEST, A DISTANCE OF 178.01 FEET; THENCE NORTH 03°21'12" WEST, A DISTANCE OF 30.02 FEET TO SAID NORTHERLY RIGHT OF WAY LINE OF KONA AVENUE; THENCE NORTH 88°30'00" EAST, A DISTANCE OF 175.53 TO THE POINT OF BEGINNING.

THE ABOVE DESCRIBED LANDS CONTAINS 5.365 SQ./FT. OR 0.12 ACRES, MORE OR LESS.
CERTIFIED TO: NORTH FLORIDA SCHOOL OF SPECIAL EDUCATION

ARLINGTON EXPRESSWAY
SERVICE ROAD

ORB 20984, PG. 2282
RE: 120885 0010
NORTH FLORIDA SCHOOL OF SPECIAL EDUCATION

ORB 11378, PG. 752

ORB 11203, PG. 718

South line of Section 14, Township 2 South, Range 27 East

My R/W Line of Kona Avenue

N88°30'00"E 175.53'

PROPOSED CLOSED
30 FEET OF KONA AVENUE

N03°21'12"W
30.02'

S88°30'00"W 178.01'

KONA AVENUE
(60' WIDE RIGHT OF WAY BY PLAT)

L1 = S47°55'39"E 14.39'
L2 = S86°57'39"W 7.81'
L3 = S03°53'56"E 19.89'

UTILITY & DRAINAGE
EASEMENT
(RESERVED BY CITY OF
JACKSONVILLE)

RE 143804-0010 NORTH
FLORIDA SCHOOL OF
SPECIAL EDUCATION INC.

APPROVED
DESCRIPTION AGREES
WITH MAP
CITY ENGINEERS OFFICE
TOPO/SURVEY BRANCH
By SCC Date 10/18/24

ALL AMERICAN SURVEYORS OF FLORIDA, INC.

LAND SURVEYORS - 3787 SAN JOSE PLACE, SUITE 15 - JACKSONVILLE, FLORIDA 32207 - 904/779-0888 - LICENSED LAND SURVEYORS NO. 3457

LEGEND
--- Easement
--- Right of Way
--- Boundary Line
--- Survey Line
--- Proposed Line
--- Existing Line
--- Utility & Drainage Easement
--- Reserved by City of Jacksonville
--- North Florida School of Special Education
--- Kona Avenue
--- Arlington Expressway Service Road
--- Oakwood Villas
--- Section 14, Township 2 South, Range 27 East
--- Duval County
--- Florida
--- United States of America

SKETCH FOR INFORMATIONAL PURPOSES ONLY - DOES
NOT REPRESENT OR PURPORT TO SHOW BOUNDARY
LINES NOR IS IT BASED ON A FIELD SURVEY

SURVEY NOT VALID UNLESS ENDORSED BY SEAL
JAMES D. HARRISON, JR., No. 2447

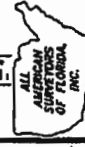

FLORIDA REGISTERED SURVEYOR AND MAPPER

DATE 12-11-2024

ORDER NO. 220370

DATE DMS/2024/02585-220370-540 Eng

DR BY WAG

D.C. N/A

F.B. N/A

FILE 92346

EXHIBIT 2

HOLD HARMLESS COVENANT

This **Hold Harmless Covenant** is hereby granted this ____ day of _____, 2025, by **North Florida School of Special Education, Inc.**, whose address is 223 Mill Creek Rd, Jacksonville, Florida 32211 ("Grantor") in favor of the **CITY OF JACKSONVILLE**, a consolidated political subdivision and municipal corporation existing under the laws of the State of Florida, whose mailing address is 117 West Duval Street, Jacksonville, Florida 32202 ("City").

IN CONSIDERATION for the closure and/or abandonment of City right-of-way or easement areas pursuant to **CITY ORDINANCE 2025-____**, a copy of which is attached hereto and incorporated by reference (the "Ordinance"), located near **RE# 120885-0035** in **Council District 1** and established in the Official Public Records of Duval County, Florida at **Plat Book 8 Page 25, Oakwood Villas Estates**.

Grantor, its successors and assigns, holds harmless, indemnifies, and will defend **CITY OF JACKSONVILLE**, its members, officials, officers, employees, and agents against any claim, action, loss, damage, injury, liability, cost and expense of whatever kind or nature (including, but not by way of limitation, attorney fees and court costs) arising out of injury (whether mental or corporeal) to persons, including death, or damage to property, arising out of or incidental to the use of the abandoned right-of-way or easement areas, more particularly described in **Exhibit "A"**, attached hereto and incorporated herein by reference (the "Property"); including, but not limited to such injuries or damages resulting from flooding or erosion. This **Hold Harmless Covenant** shall run with the real property described in **Exhibit "A"**. The adjacent property owner(s) who acquire the Property as a result of the abandonment shall be responsible for maintaining the Property.

Furthermore, the Property shall remain totally unobstructed by any permanent improvements that may impede the use by the City or JEA of their reserved easement rights, if any, under the provisions of the reserved easement and/or the Ordinance. In the event that such easement rights are reserved by City or JEA: (a) the construction of driveways and the installation of fences, hedges, and landscaping is permissible but subject to removal or damage by the City or JEA at the expense of the Grantor, its successors and assigns, for any repairs to or replacement of the improvements; and (b) Grantor, its successors and assigns, shall indemnify, defend, and hold City and JEA harmless from, any and all loss, damage, action, claim, suit, judgment, cost, or expense for injury to persons (including death) or damage to property and improvements (including destruction), in any manner resulting from or arising out of the installation, replacement, maintenance or failure to maintain, or removal of any improvements placed within the easement area by Grantor, its successors or assigns, and the City's or JEA's exercise of their rights in the reserved easement.

**Signed and Sealed
in Our Presence:**

GRANTOR:

(Sign) _____

By: _____

(Print) _____

Name:

Title:

(Sign) _____

(Print) _____

**STATE OF FLORIDA
COUNTY OF DUVAL**

The foregoing instrument was acknowledged before me by means of ☐ physical presence or ☐ online notarization, this ____ day of _____ 2025, by _____.

(NOTARY SEAL)

[Signature of Notary Public-State of Florida]

[Name of Notary Typed, Printed, or Stamped]

Personally Known _____ OR Produced Identification _____

Type of Identification Produced _____

MAP SHOWING SKETCH & DESCRIPTION OF A PORTION OF SECTION 52, TOWNSHIP 2 SOUTH, RANGE 27 EAST, DUVAL COUNTY, FLORIDA

PROPOSED CLOSING OF A PORTION OF KONA AVENUE RIGHT OF WAY:

FOR A PORT OF BEGINNING, COMMENCE AT THE INTERSECTION OF THE NORTHERLY RIGHT OF WAY LINE OF KONA AVENUE AND 80 FOOT RIGHT OF WAY AS PER THE PLAT OF OAKWOOD VILLAS, PLAT BOOK 8, PAGE 23 OF DUVAL COUNTY & THE SOUTHWESTERLY RIGHT OF WAY LINE OF ARLINGTON EXPRESSWAY SERVICE ROAD; THENCE SOUTH 47°56'39" EAST, ALONG SAID SOUTHWESTERLY RIGHT OF WAY LINE OF ARLINGTON EXPRESSWAY SERVICE ROAD, A VARIABLE WIDTH RIGHT OF WAY AS PRESENTLY ESTABLISHED, A DISTANCE OF 14.39 FEET; THENCE SOUTH 86°57'39" WEST, ALONG SAID SOUTHWESTERLY RIGHT OF WAY LINE OF ARLINGTON EXPRESSWAY SERVICE ROAD, A DISTANCE OF 7.81 FEET; THENCE SOUTH 03°53'56" EAST, A DISTANCE OF 19.89 FEET; THENCE SOUTH 88°30'00" WEST, A DISTANCE OF 178.01 FEET; THENCE NORTH 03°21'12" WEST, A DISTANCE OF 30.02 FEET TO SAID NORTHERLY RIGHT OF WAY LINE OF KONA AVENUE; THENCE NORTH 88°30'00" EAST, A DISTANCE OF 175.53 TO THE POINT OF BEGINNING.

THE ABOVE DESCRIBED LANDS CONTAINS 5.365 SQ./FT. OR 0.12 ACRES, MORE OR LESS.

CERTIFIED TO: NORTH FLORIDA SCHOOL OF SPECIAL EDUCATION

ARLINGTON EXPRESSWAY
SERVICE ROAD

ORB 20984, PG. 2282
RE:120885-0010
NORTH FLORIDA SCHOOL OF SPECIAL EDUCATION

ORB 11378, PG. 752

ORB 11203, PG. 718

N88°30'00"E

175.53'

PROPOSED CLOSED
30 FEET OF KONA AVENUE

N03°21'12"W

30.02'

KONA AVENUE

(60' WIDE RIGHT OF WAY BY PLAT)

178.01'

POINT OF BEGINNING
NORTH FLORIDA SCHOOL OF SPECIAL EDUCATION

UTILITY & DRAINAGE
EASEMENT
(RESERVED BY CITY OF JACKSONVILLE)

RE:143804-0010 NORTH
FLORIDA SCHOOL OF
SPECIAL EDUCATION INC.

L1 = S47°56'39"E 14.39'
L2 = S86°57'39"W 7.81'
L3 = S03°53'56"E 19.89'

APPROVED
DESCRIPTION AGREES
WITH MAP
CITY ENGINEERS OFFICE
TOPO/SURVEY BRANCH
By see Date 10/10/14

ALL AMERICAN SURVEYORS OF FLORIDA, INC.

LAND SURVEYOR - 3781 SAW JOSE PLAZA, SUITE 15 - JACKSONVILLE, FLORIDA 32217 - 904/279-0088 - LICENSED LAND SURVEYOR NO. 3057

LEGEND

- 1. - BOUNDARY SURVEY
- 2. - EASEMENT
- 3. - RIGHT OF WAY
- 4. - PLAT
- 5. - RECORD
- 6. - DEED
- 7. - CONTRACT
- 8. - AGREEMENT
- 9. - ORDER
- 10. - DECISION
- 11. - JUDGMENT
- 12. - WRIT
- 13. - WRIT OF HABEAS CORPUS
- 14. - WRIT OF HABEAS ADAMANTIA
- 15. - WRIT OF HABEAS DATA
- 16. - WRIT OF HABEAS FIDELITY
- 17. - WRIT OF HABEAS HABITAT
- 18. - WRIT OF HABEAS HOMER
- 19. - WRIT OF HABEAS LIBERTY
- 20. - WRIT OF HABEAS MARRIAGE
- 21. - WRIT OF HABEAS PARENTS
- 22. - WRIT OF HABEAS SUI JURIS
- 23. - WRIT OF HABEAS TESTAMENTARY
- 24. - WRIT OF HABEAS TRUST
- 25. - WRIT OF HABEAS VITIUM
- 26. - WRIT OF HABEAS VITIUM
- 27. - WRIT OF HABEAS VITIUM
- 28. - WRIT OF HABEAS VITIUM
- 29. - WRIT OF HABEAS VITIUM
- 30. - WRIT OF HABEAS VITIUM

- NOTE:
- THIS IS NOT A BOUNDARY SURVEY AND DOES NOT PURPORT TO BE SUCH.
 - THE EXISTING PURPOSE OF THIS SURVEY IS TO SHOW A SKETCH OF THE DESCRIPTION OF THE PORTION OF KONA AVENUE BEING CLOSED.

SKETCH FOR INFORMATIONAL PURPOSES ONLY - DOES NOT REPRESENT OR PURPORT TO SHOW BOUNDARY LINES NOR IS IT BASED ON A FIELD RUN SURVEY

SURVEY NOT VALID UNLESS ENDORSED BY SEAL

JAMES D. HARRISON, JR., No. 2847

SCALE 1" = 20'

DATE 12-10-2014

FLORIDA REGISTERED SURVEYOR AND MAPPER

FILE 97585 ORDER NO. 220270-540 eng OR. DMC/7024/92585-220270-540 eng

LEGISLATIVE FACT SHEET

DATE: 03/27/25

BT or RC No: _____
(Administration & City Council Bills)

SPONSOR: Public Works/Real Estate in Councilmember Ken Amaro's District 1
(Department/Division/Agency/Council Member)

Contact for all inquiries and presentations: Renee Hunter

Provide Name: Renee Hunter, Chief, Real Estate Division

Contact Number: 904-255-8234

Email Address: reneeh@coj.net

PURPOSE: White Paper (Explain Why this legislation is necessary? Provide; Who, What, When, Where, How and the Impact.) Council Research will complete this form for Council introduced legislation and the Administration is responsible for all other legislation.

(Minimum of 350 words - Maximum of 1 page.)

Please provide authorization for the Public Works Real Estate Division to request the legislation necessary for the City Council to approve the closure and abandonment of an unopened and unimproved portion of Kona Avenue, as recorded in Plat Book 8, Pages 23-25, Oakwood Villa Estates, of the Current Public Records of Duval County, Florida. See maps attached and RE# 120885-0035 for location purposes.

The Applicant, North Florida School of Special Education, Inc., has requested the closure to connect its adjacent properties and create the additional parking required under the code as a result of renovating and utilizing the former Lee & Cates building for special needs clients. The applicant has paid the \$2,091.00 closure application fee. No City, State, or other agency has objected to this closure request.

An all-utilities, facilities, and access easement will be reserved over the closure area in favor of the City and JEA.

APPROPRIATION: Total Amount Appropriated: _____ as follows:

List the source name and provide Object and Subobject Numbers for each category listed below:

(Name of Fund as it will appear in title of legislation)

Name of Federal Funding Source(s):	From: _____	Amount: _____
	To: _____	Amount: _____

Name of State Funding Source(s):	From: _____	Amount: _____
	To: _____	Amount: _____

Name of City of Jacksonville Funding Source(s):	From: _____	Amount: _____
	To: _____	Amount: _____

Name of In-Kind Contribution(s):	From: _____	Amount: _____
	To: _____	Amount: _____

Name & Number of Bond Account(s):	From: _____	Amount: _____
	To: _____	Amount: _____

PLAIN LANGUAGE OF APPROPRIATION / FINANCIAL IMPACT / OTHER:

Explain: Where are the funds coming from, going to, how will the funds be used? Does the funding require a match? Is the funding for a specific time frame? Will there be an ongoing maintenance? ... and staffing obligation? Per Chapters 122 & 106 regarding funding of anticipated post-construction operation costs.

(Minimum of 350 words - Maximum of 1 page.)

The applicant has paid the \$2,091.00 closure application fee which has been deposited in the General Fund 00111.152001.349070.000000.00000000.000000.

ACTION ITEMS: Purpose / Check List. If "Yes" please provide detail by attaching justification, and code provisions for each.

ACTION ITEMS:

	Yes	No	
Emergency?	<input type="checkbox"/>	<input checked="" type="checkbox"/>	Justification of Emergency: If yes, explanation must include detailed nature of emergency. <div style="border: 1px solid black; height: 30px; margin-top: 5px;"></div>
Federal or State Mandate?	<input type="checkbox"/>	<input checked="" type="checkbox"/>	Explanation: If yes, explanation must include detailed nature of mandate including Statute or Provision. <div style="border: 1px solid black; height: 30px; margin-top: 5px;"></div>
Fiscal Year Carryover?	<input type="checkbox"/>	<input checked="" type="checkbox"/>	Note: If yes, note must include explanation of all-year subfund carryover language. <div style="border: 1px solid black; height: 30px; margin-top: 5px;"></div>
CIP Amendment?	<input type="checkbox"/>	<input checked="" type="checkbox"/>	Attachment: If yes, attach appropriate CIP form(s). Include justification for mid-year amendment.
Contract / Agreement Approval?	<input checked="" type="checkbox"/>	<input type="checkbox"/>	Attachment & Explanation: If yes, attach the Contract / Agreement and name of Department (and contact name) that will provide oversight. Indicate if negotiations are on-going and with whom. Has OGC reviewed / drafted? OGC has approved the hold harmless covenant template. <div style="border: 1px solid black; height: 30px; margin-top: 5px;"></div>
Related RC/BT?	<input type="checkbox"/>	<input checked="" type="checkbox"/>	Attachment: If yes, attach appropriate RC/BT form(s).
Waiver of Code?	<input type="checkbox"/>	<input checked="" type="checkbox"/>	Code Reference: If yes, identify code section(s) in box below and provide detailed explanation (including impacts) within white paper. <div style="border: 1px solid black; height: 30px; margin-top: 5px;"></div>
Code Exception?	<input type="checkbox"/>	<input checked="" type="checkbox"/>	Code Reference: If yes, identify code in box below and provide detailed explanation (including impacts) within white paper. <div style="border: 1px solid black; height: 30px; margin-top: 5px;"></div>
Related Enacted Ordinances?	<input type="checkbox"/>	<input checked="" type="checkbox"/>	Code Reference: If yes, identify related code section(s) and ordinance reference number in the box below and provide detailed explanation and any changes necessary within white paper. <div style="border: 1px solid black; height: 30px; margin-top: 5px;"></div>

ACTION ITEMS CONTINUED: Purpose / Check List. If "Yes" please provide detail by attaching justification, and code provisions for each.

ACTION ITEMS:

	Yes	No	
Continuation of Grant?	<input type="checkbox"/>	<input checked="" type="checkbox"/>	<p>Explanation: How will the funds be used? Does the funding require a match? Is the funding for a specific time frame and/or multi-year? If multi-year, note year of grant? Are there long-term implications for the General Fund?</p> <div style="border: 1px solid black; height: 40px; width: 100%;"></div>
Surplus Property Certification?	<input type="checkbox"/>	<input checked="" type="checkbox"/>	<p>Attachment: If yes, attach appropriate form(s).</p>
Reporting Requirements?	<input type="checkbox"/>	<input checked="" type="checkbox"/>	<p>Explanation: List agencies (including City Council / Auditor) to receive reports and frequency of reports, including when reports are due. Provide Department (include contact name and telephone number) responsible for generating reports.</p> <div style="border: 1px solid black; height: 30px; width: 100%;"></div>

BUSINESS IMPACT ESTIMATE

Pursuant to Section 166.041(4), F.S., the City is required to prepare a Business Impact Estimate for ordinances that are NOT exempt from this requirement. A list of ordinance exemptions are provided below. Please check all exemption boxes that apply to this ordinance. If an exemption is applicable, a Business Impact Estimate IS NOT required.

- ☒ The proposed ordinance is required for compliance with Federal or State law or regulation (Florida Statute 336.09);
- ☐ The proposed ordinance relates to the issuance or refinancing of debt;
- ☐ The proposed ordinance relates to the adoption of budgets or budget amendments, including revenue sources necessary to fund the budget;
- ☐ The proposed ordinance is required to implement a contract or an agreement, including, but not limited to, any Federal, State, local, or private grant or other financial assistance accepted by the municipal government;
- ☐ The proposed ordinance is an emergency ordinance;
- ☐ The ordinance relates to procurement; or
- ☐ The proposed ordinance is enacted to implement the following:
 - a. Part II of Chapter 163, Florida Statutes, relating to growth policy, county and municipal planning, and land development regulation, including zoning, development orders, development agreements and development permits;
 - b. Sections 190.005 and 190.046, Florida Statutes, regarding community development districts;
 - c. Section 553.73, Florida Statutes, relating to the Florida Building Code; or
 - d. Section 633.202, Florida Statutes, relating to the Florida Fire Prevention Code.

If none of the boxes above are checked, then a Business Impact Estimate IS REQUIRED to be prepared by the using agency/office/department and submitted in the MBRC filing packet along with the memorandum request, legislative fact sheet, etc. A Business Impact Estimate form can be found at: <https://www.coj.net/departments/finance/budget/mayor-s-budget-review-committee>

Division Chief: [Signature]
(signature)

Date: 3/27/2025

Prepared By: [Signature]
(signature)

Date: 3/27/2025

ADMINISTRATIVE TRANSMITTAL

To: MBRC, c/o the Budget Office, St. James Suite 325

Thru: Nina Sickler, P.E., Director Public Works

(Name, Job Title, Department)

Phone: 255-8748

E-mail: NSickler@coj.net

From: Renee Hunter, Chief, Real Estate

Initiating Department Representative (Name, Job Title, Department)

Phone: 255-8234

E-mail: ReneeH@coj.net

Primary Contact: Renee Hunter, Chief, Real Estate

(Name, Job Title, Department)

Phone: 255-8234

E-mail: ReneeH@coj.net

CC: Brittany Norris, Director of Intergovernmental Affairs, Office of the Mayor

Phone: 255-5000

E-mail: BNorris@coj.net

COUNCIL MEMBER / INDEPENDENT AGENCY / CONSTITUTIONAL OFFICER TRANSMITTAL

To: John Sawyer, Office of General Counsel, St. James Suite 480
Phone: 904-255-5074 E-mail: JSawyer@coj.net

From: _____
Initiating Council Member / Independent Agency / Constitutional Officer
Phone: _____ E-mail: _____

Primary Contact _____
(Name, Job Title, Department)
Phone: _____ E-mail: _____

CC: Brittany Norris, Director of Intergovernmental Affairs, Office of the Mayor
Phone: 255-5000 E-mail: BNorris@coj.net

Legislation from Independent Agencies requires a resolution from the Independent Agency Board approving the legislation.

Independent Agency Action Item:

Boards Action / Resolution?

Yes	No
<input type="checkbox"/>	<input type="checkbox"/>

Attachment: If yes, attach appropriate documentation. If no, when is board action scheduled?

FACT SHEET IS REQUIRED BEFORE LEGISLATION IS INTRODUCED

Business Impact Estimate

This form must be posted on the City of Jacksonville's website by the time notice of the proposed ordinance is published.

ORDINANCE NUMBER TO BE ASSIGNED (2025-____) title of ordinance AN ORDINANCE CLOSING AND ABANDONING AND/OR DISCLAIMING AN UNOPENED AND UNIMPROVED PORTION OF KONA AVENUE, ESTABLISHED IN THE PLAT OF OAKWOOD VILLAS ESTATES, AS RECORDED IN PLAT BOOK 8, PAGE 23-25 OF THE CURRENT PUBLIC RECORDS OF DUVAL COUNTY, FLORIDA, IN COUNCIL DISTRICT 1, AT THE REQUEST OF NORTH FLORIDA SCHOOL OF SPECIAL EDUCATION.; PROVIDING FOR APPROVAL SUBJECT TO CONDITIONS; PROVIDING AN EFFECTIVE DATE.

Summary of the proposed ordinance: AN ORDINANCE CLOSING AND ABANDONING AND/OR DISCLAIMING AN UNOPENED AND UNIMPROVED PORTION OF KONA AVENUE, ESTABLISHED IN THE PLAT OF OAKWOOD VILLAS ESTATES, AS RECORDED IN PLAT BOOK 8, PAGE 23-25 OF THE CURRENT PUBLIC RECORDS OF DUVAL COUNTY, FLORIDA, IN COUNCIL DISTRICT 1, AT THE REQUEST OF NORTH FLORIDA SCHOOL OF SPECIAL EDUCATION.; PROVIDING FOR APPROVAL SUBJECT TO CONDITIONS; PROVIDING AN EFFECTIVE DATE.

An estimate of the direct economic impact of the proposed ordinance: \$2,091 CLOSURE APPLICATION FEE HAS BEEN DEPOSITED INTO THE GENERAL FUND. THIS LEGISLATION WILL NOT REQUIRE BUSINESSES TO INCUR ANY DIRECT COMPLIANCE COSTS NOR WILL ANY NEW CHARGES OR FEES BE ASSESSED BY THIS LEGISLATION FOR WHICH BUSINESSES WILL BE FINANCIALLY RESPONSIBLE.

Good faith estimate of the number of businesses likely to be impacted by the proposed ordinance: NONE OTHER THAN APPLICANT.

Additional information the governing body deems useful (if any): N/A